

Frame anchor with countersunk head HRD-C



Base materials

- Concrete (aerated)
- Concrete (cracked)
- Concrete (hollow deck)
- Concrete (uncracked)
- Masonry (grout-filled CMU)
- Masonry (hollow)
- Masonry (hollow CMU)
- Masonry (solid)

Applications

- Typical applications for metal fabricators such as fastening handrails, window bars, railings, balustrades, etc.
- Fastening wooden substructures for ventilated facades
- Fastening door and window frames

Advantages

- Flexible embedment depth (approved at 50 mm and 70 mm embedment depth) - the ideal anchor for a huge range of applications in virtually all base materials
- Available in 3 different materials for optimum suitability in all corrosive environments
- Pre-assembled for optimum handling and fastening quality

Technical data

Material composition	Steel, zinc-plated (min. 5 µm), Polyamide
Head configuration	Countersunk
Suitable for cracked concrete with redundant fastenings	Yes

Approvals

ETA | ETA-07/0219 for HRD (ETAG 020-01, Option -)

Approvals and test reports may apply to selected products only. Please refer to the documents for details.

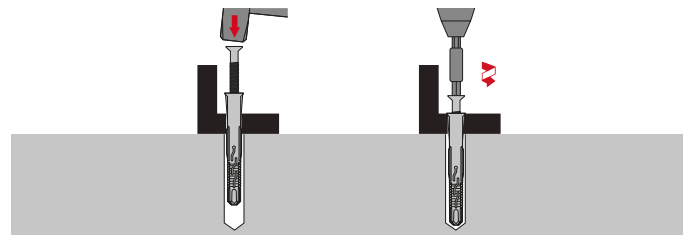

These are abbreviated instructions which may vary by application. Always review/follow the instructions accompanying the product or refer to www.hilti.com/techlib.

Ordering designation	Drill bit diameter	Anchor length	Embedment depth 1	Embedment depth 2	Bit size	Fastening thickness at embed.2	Sales pack quantity	Item number
HRD-C 8x60	8 mm	60 mm	50 mm		T30		50 pc	202341 ¹⁾
HRD-C 8x80	8 mm	80 mm	50 mm		T30		50 pc	202342 ¹⁾
HRD-C 10x60	10 mm	60 mm	50 mm		T40		50 pc	423859 ¹⁾
HRD-C 10x80	10 mm	80 mm	50 mm	70 mm	T40	10 mm	50 pc	423860 ¹⁾
HRD-C 10x100	10 mm	100 mm	50 mm	70 mm	T40	30 mm	50 pc	423861 ¹⁾
HRD-C 10x120	10 mm	120 mm	50 mm	70 mm	T40	50 mm	50 pc	423862 ¹⁾

¹⁾ This is a non-stock item. For detailed lead time information please contact your Hilti representative.

Please visit our website for the latest item numbers and related products.