

	$d_0$ [mm]	$d_f$ [mm]	$h_{ef}$ [mm]	$l_p$ [mm]	$\Delta$ [mm]	$h_{min}$ [mm]	$t_{fix}$ [mm]	$T_{inst}$ [mm]	SW [mm]
HIT-Z-D TP	18	20	125	$\geq 35$	$2 \times d_0$	160	$l - 160 \geq 10$	80	24
HIT-Z-R-D TP	18	20	125	$\geq 35$	$2 \times d_0$	160	$l - 160 \geq 10$	155	24

+5°...40°C / 41°...104°F

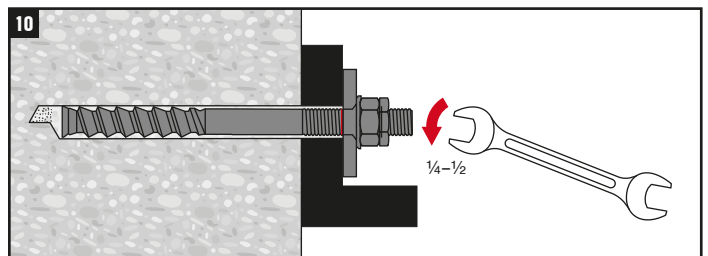

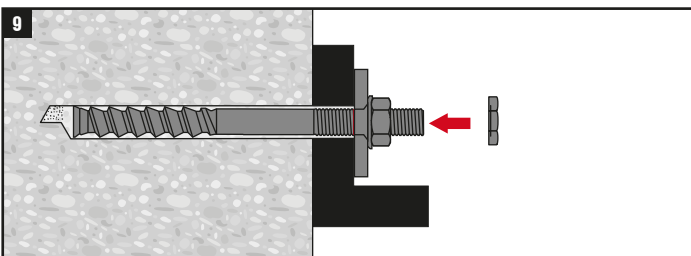
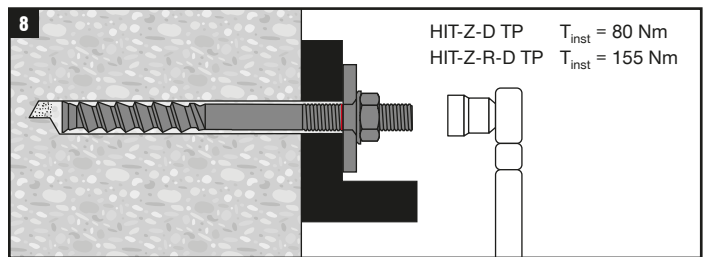
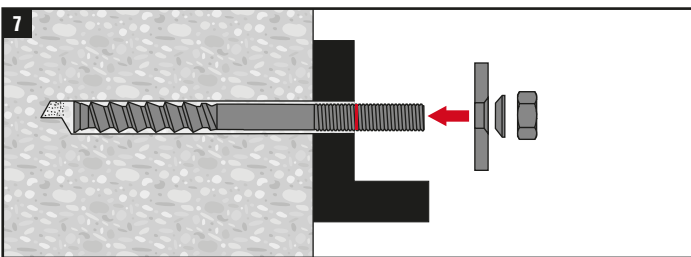
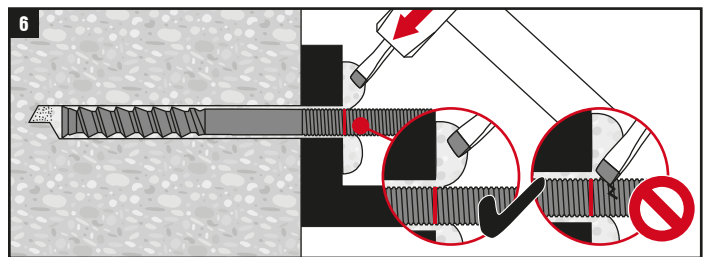
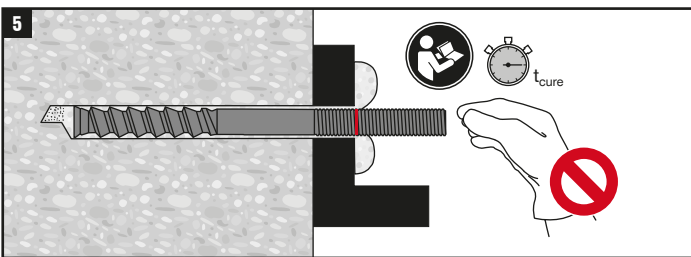
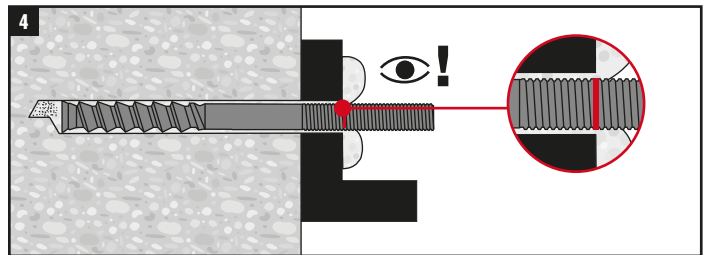
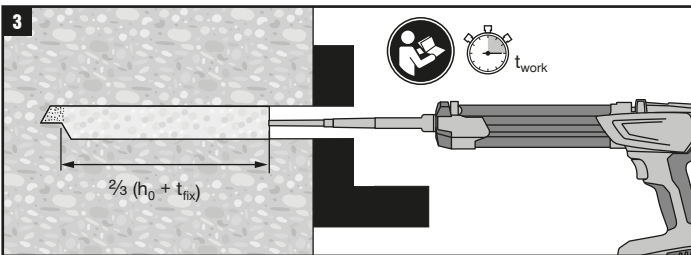
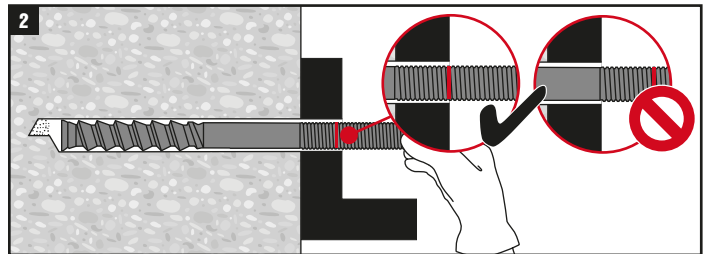
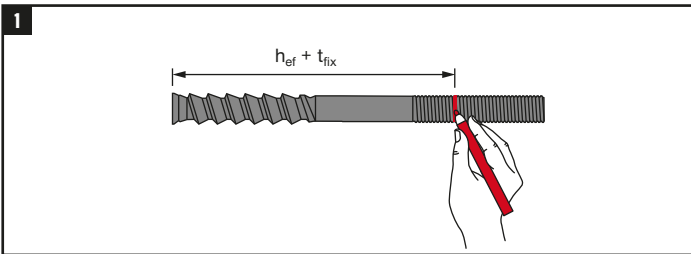
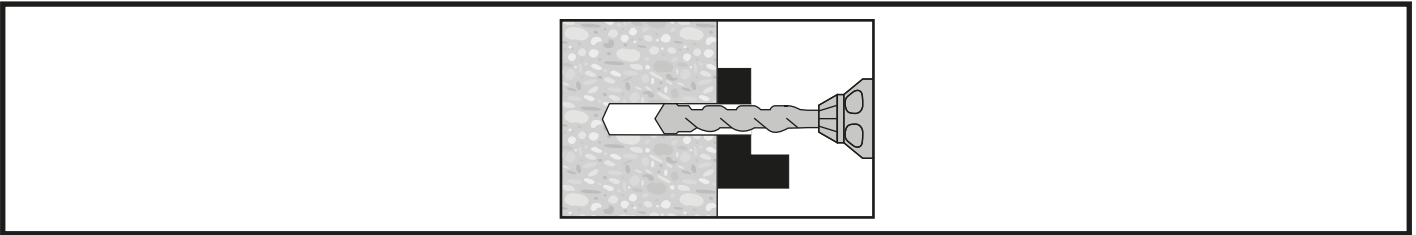
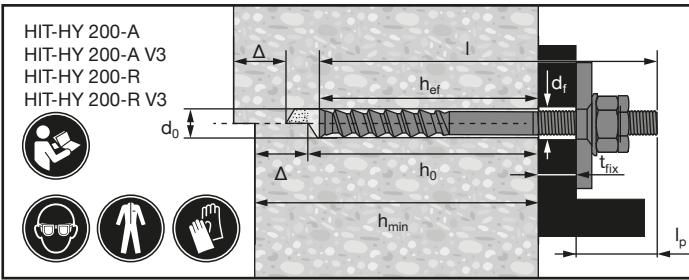

	d <sub>0</sub> [mm]	d <sub>f</sub> [mm]	h <sub>ef</sub> [mm]	l <sub>p</sub> [mm]	Δ [mm]	h <sub>min</sub> [mm]	t <sub>fix</sub> [mm]	T <sub>inst</sub> [mm]	SW [mm]
HIT-Z-D TP	18	20	125	≥35	2 x d <sub>0</sub>	160	l - 160 ≥ 10	80	24
HIT-Z-R-DTP	18	20	125	≥35	2 x d <sub>0</sub>	160	l - 160 ≥ 10	155	24

+5°...40°C / 41°...104°F

